

AREA 42

a place.

an event.

Rue des Palais, 42 - 46A / 1030 Bruxelles

Tél. : +32 (0)2 218 16 41

Fax : +32 (0)2 218 07 41

Courriel : vanessa.cano@area42.be

Contact : Vanessa Cano

Web : www.area42.be



Not far from the « Little Manhattan » and at a few steps from the « Botanic Garden » and the Bloom Hotel, AREA 42 is an unique modular contemporary space located in the prestigious old RTT building, one of the architect Michel Polak's latest achievements. Area 42 is made up of two levels with a total surface of 2,500 sqm and can host 1200 people.

It includes a 300 sits conference room with a garden square (AREA1), 2 double rooms framing a court yard with a vegetal wall (AREA 2), 2 subspaces separated by acoustics curtains (AREA 3), a 521 square meters room with a ceiling made from glass blocks (AREA 4) and its VIP Room. Kitchen and lift have been specially elaborated for catering.



AREA 42 offers an experience in an “out of the box” venue set in an inspiring location designed by a team of contemporary artists.

With its dedicated original works, its designer furniture, its exclusive prototypes, its rare and prestigious materials, the venue has its own truly unique identity.



AREA 42 is regularly visited by young artists who come to recharge their batteries and engage in their artistic discipline. The AREA 42 can arrange the set up of the event as an art Gallery and so you benefit from a creative atmosphere constantly renewed.

AREA 42 also offers an original artistic & cultural program : concert, exhibitions, artistic performances



Seminars : Conference room from 100 to 300 people
+ 3 meeting rooms from 40 to 70 people.

Sitting Receptions : 100 to 250 people with view to
the stage. Max 500 people by level.

Walking dinner : 100 to 1 200 people



**Free from caterer and technics : you rent empty rooms
with optional services**

**0 R All In offer for Conferences and Parties in
partnership with our best suppliers**

**Private Parking of 140 places in evenings and weekend
and 20 places at daytime.**

**Special rates with the public parking *Passage 44*
located at 1km.**

Free 2 way shuttle service for the first 100 guests.



AREA 1 / 267m²

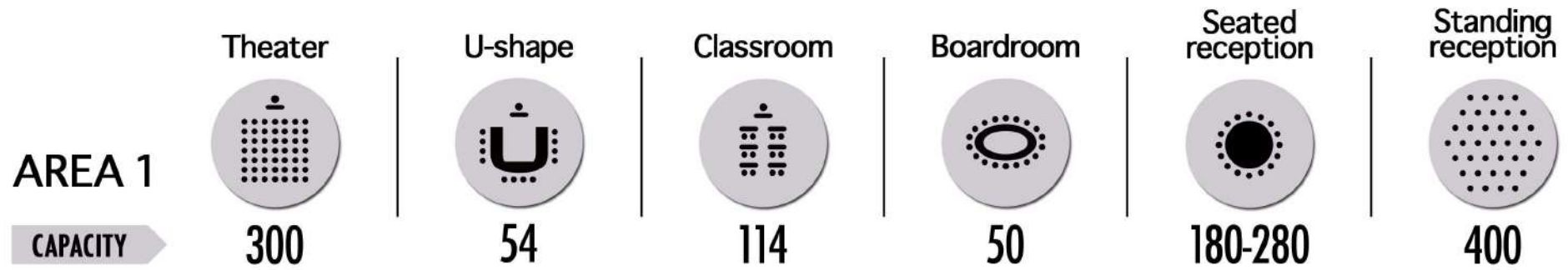





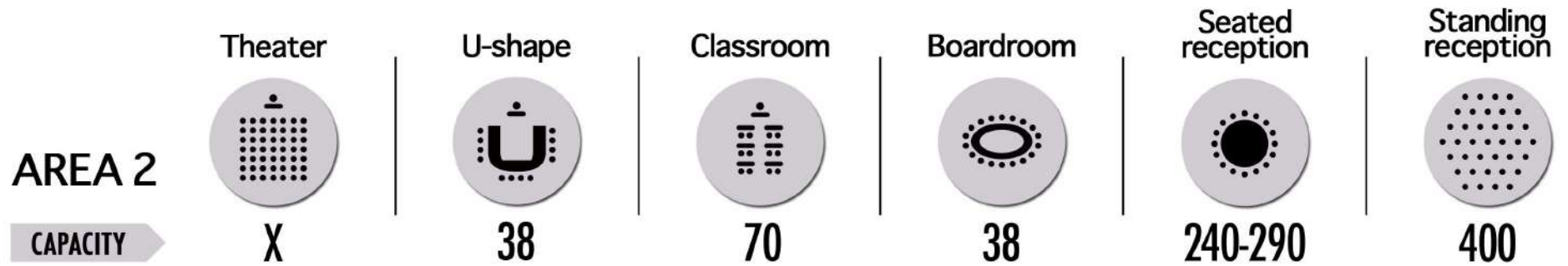



AREA 2 / 361m²





AREA 3 / 244 m²

	Theater	U-shape	Classroom	Boardroom	Seated reception	Standing reception
AREA 3						
SPACE1	70	30	50	30	100	—
SPACE2	70	30	50	30	90	—
CAPACITY	140	60	56	60	190	240



AREA 4 / 520 m²

	Theater	U-shape	Classroom	Boardroom	Seated reception	Standing reception
AREA 4						
MAIN SPACE	400	60	120	100	250-350	980
VIP ROOM	90	30	50	30	90	—
CAPACITY	490	90	148	130	440	980

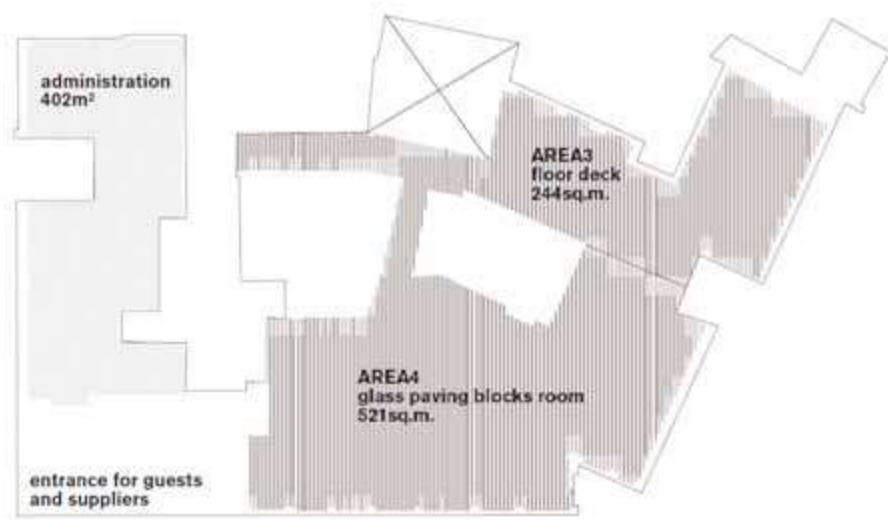

Level 1 : 1384 square meters
 AREA 3 : 2 Subspaces : 244 sm
 AREA 4 : Glass paving blocks room : 521 sm
 Entrance, Cloakroom, storage room

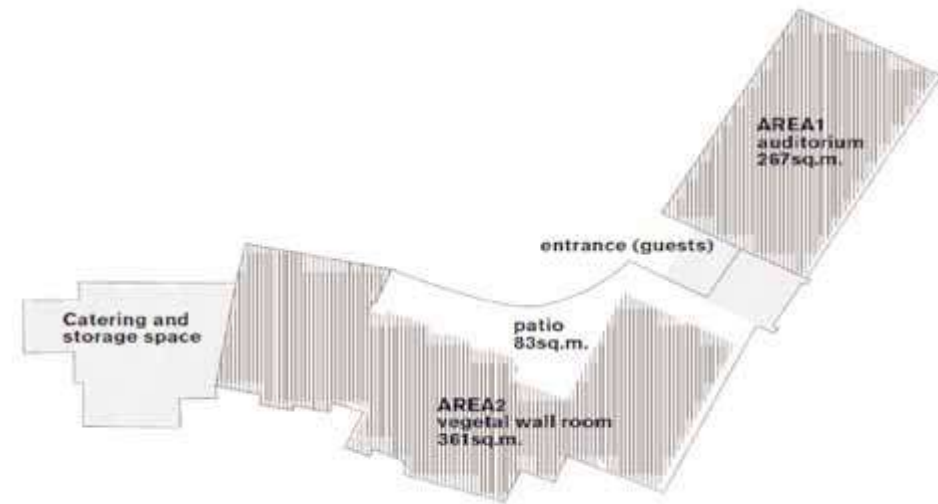

Level 2 : 1036 square meters
 AREA1 : The auditorium : 267 sm
 AREA2 : Vegetal Wall Room : 361sm
 Entrance, cloakroom, catering and storage room

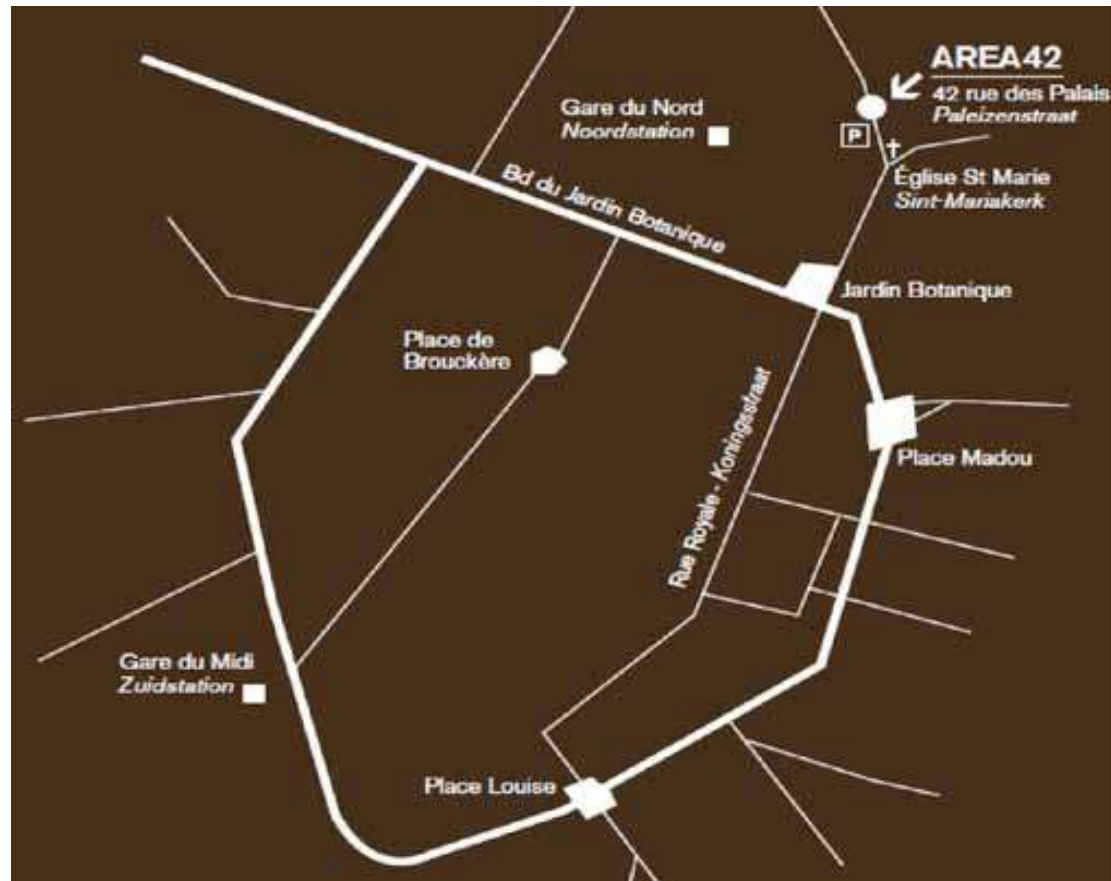

TRAM : Sainte-Marie stop
Tram 94 - Stade - Stadion/Hermann Debrox
Tram 92 - Schaerbeek train station/ Fort Jaco
BUS : Sainte-Marie stop
Lines 270-271-272-351-358
METRO : Botanique (900m)
Station : Gare du Nord (900 m)
12km from Brussels Airport

**Private parking : 20 spots from 9am to 6pm –
140 spots from 6pm to 6am and week-ends -
Special rates with public Parking Passage 44
at 1km
Free 2 way shuttle service for the first 100
guests.**